

Cylinder Compatible with “Lockwood” Locks



Application

Compatible with “Lockwood” type lock cases.

Operation

360° rotation by operating key.

Materials

Body and plug: high quality brass

Cam: steel

Pins: nickel silver and stainless steel

Standard finishes

Nickel satin, brass

Cylinder mechanism

Mul-T-Lock's unique, high precision pin tumbler system.

Keys

Reversible nickel silver key with plastic key head and colored insert. Also available in all nickel silver.

Cylinder options

- Classic, Interactive[®]+, MT5[®] platforms
- '3 IN 1' (changeable combination)
- Keyed different, keyed alike
- Master keyed

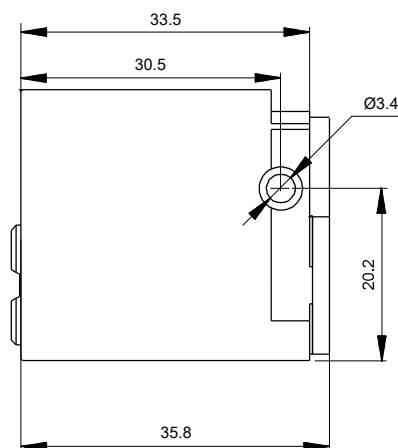
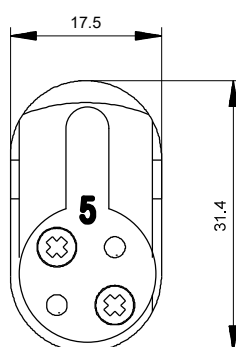

www.mul-t-lock.com